

# Multipoint Lock Fitting Instructions

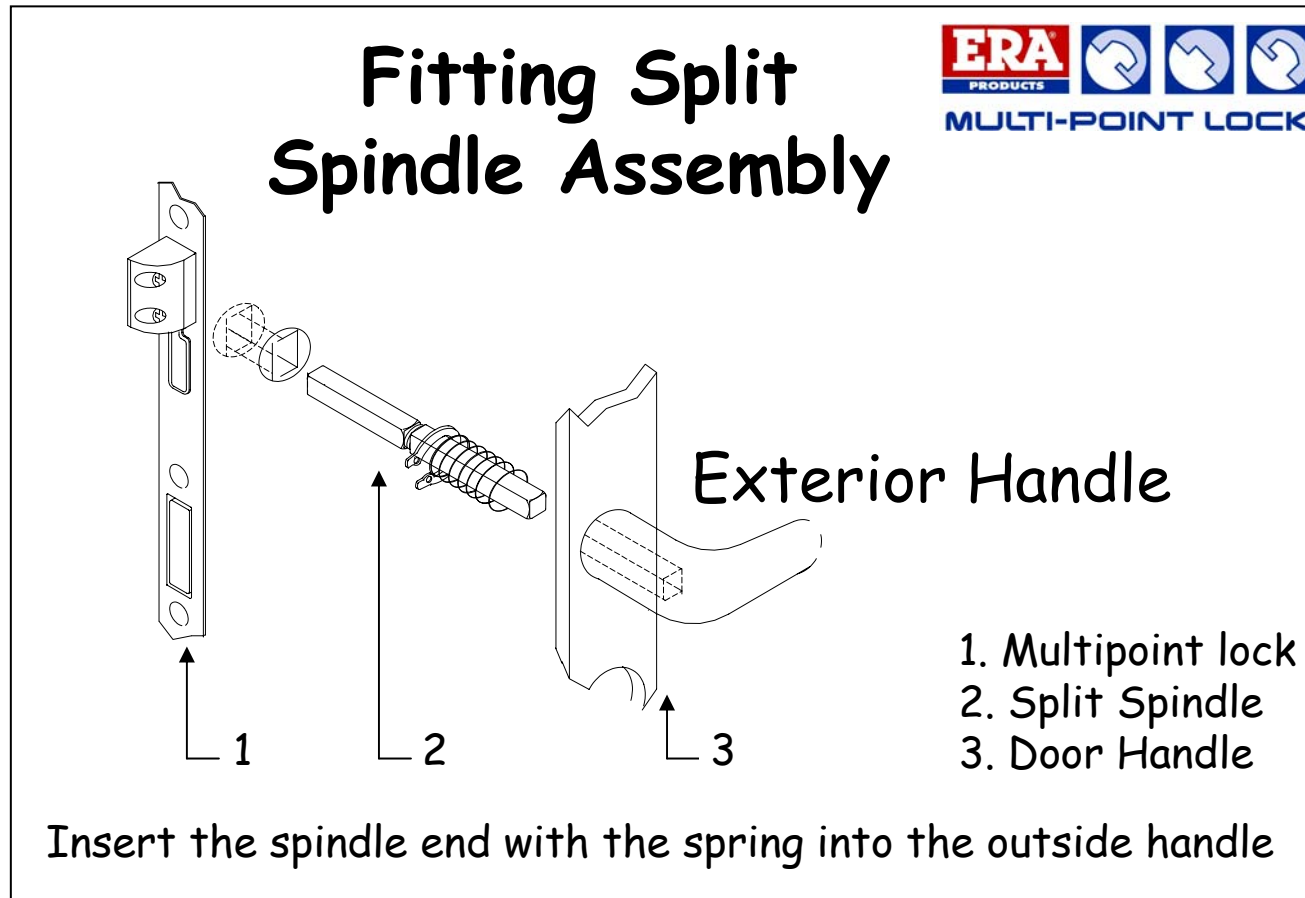

## Technical Guide



## Multipoint Lock Fitting Instructions

### Reversing the sash (latch) bolt

## Technical Guide

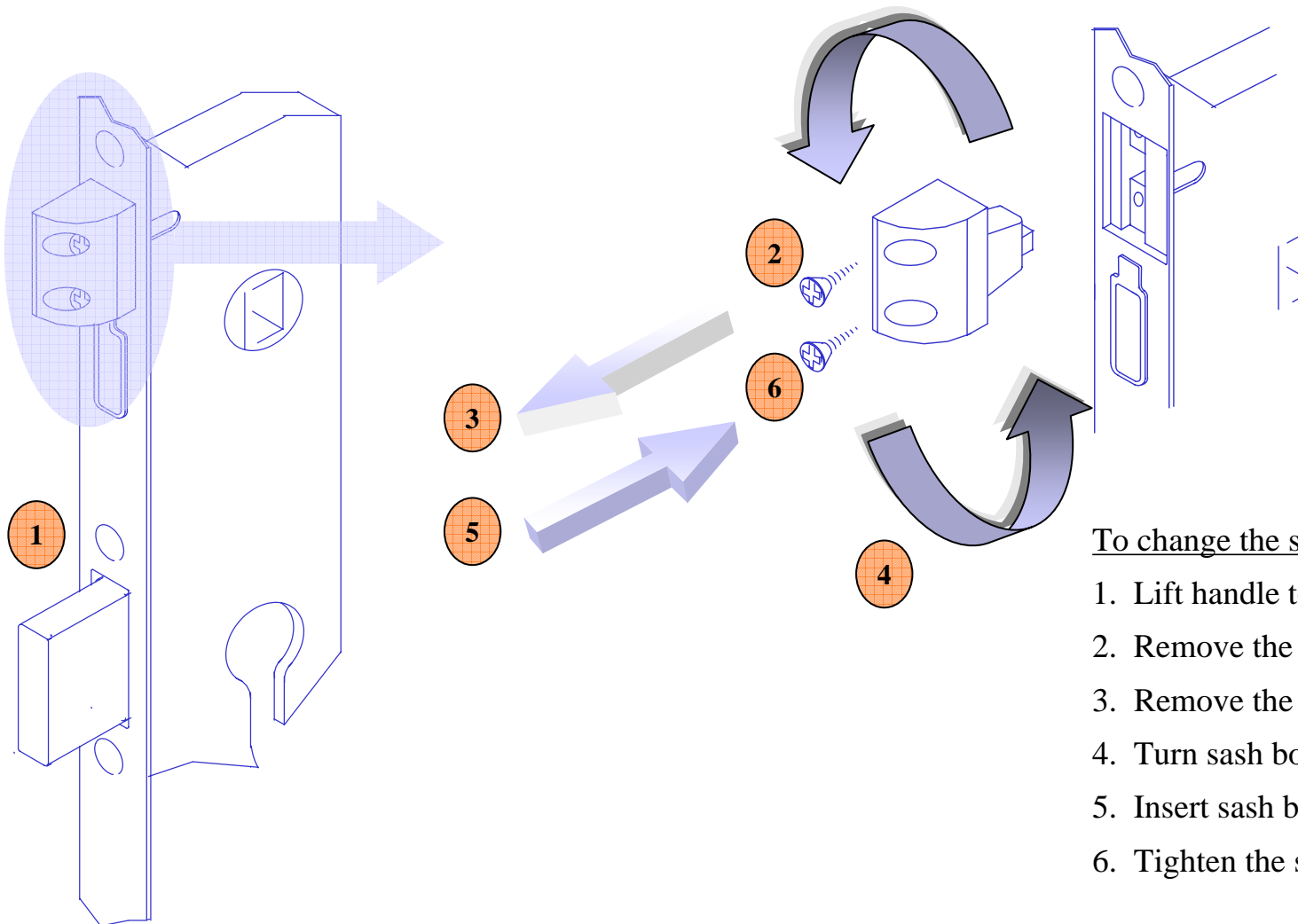

### To change the sash (latch) bolt handing

1. Lift handle to fully throw the deadbolt
2. Remove the screws
3. Remove the sash bolt
4. Turn sash bolt 180°
5. Insert sash bolt
6. Tighten the screws

## Multipoint Lock Fitting Instructions

### Using Split Spindle for Nightlatch Function

## Technical Guide

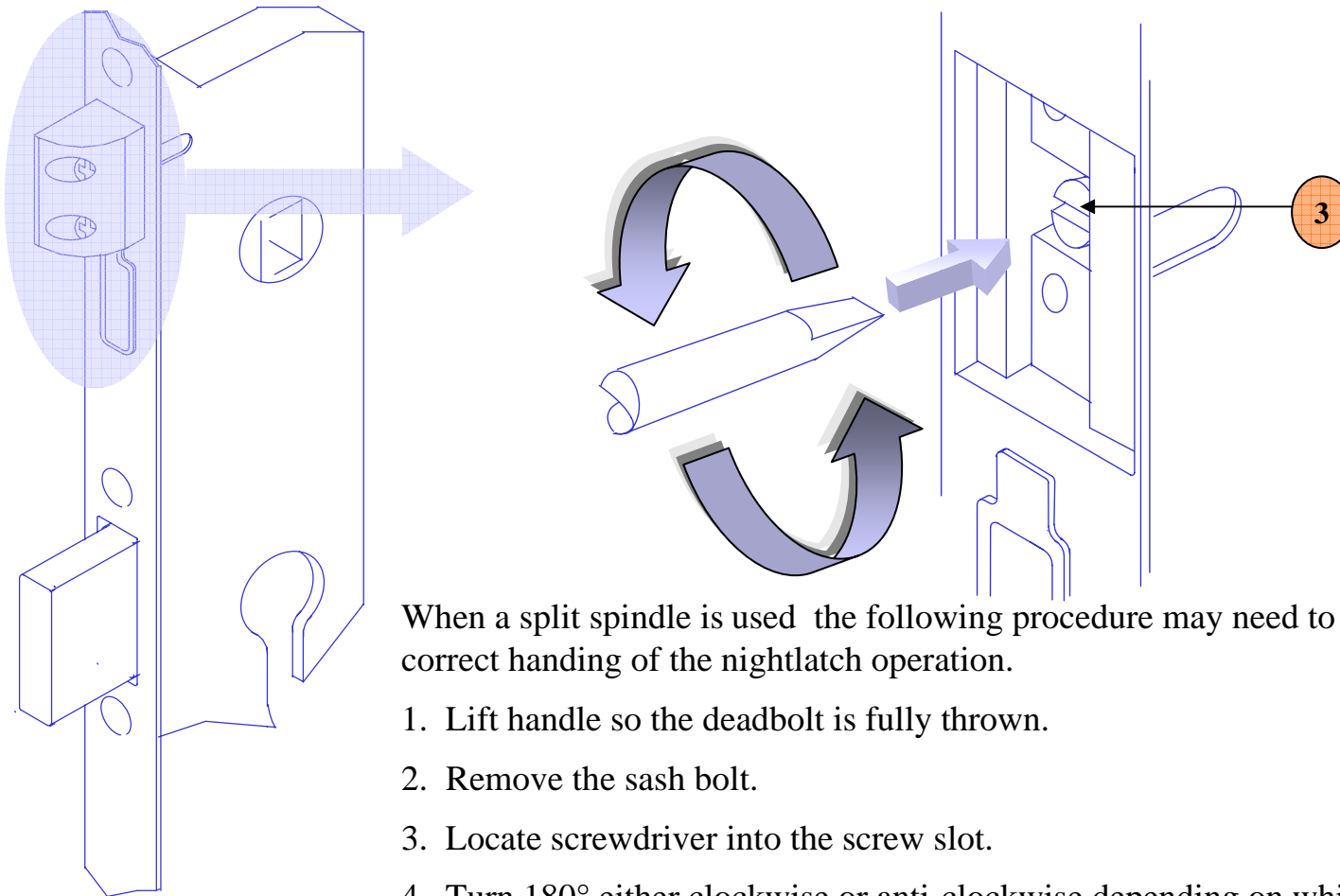

When a split spindle is used the following procedure may need to be carried out to ensure correct handing of the nightlatch operation.

1. Lift handle so the deadbolt is fully thrown.
2. Remove the sash bolt.
3. Locate screwdriver into the screw slot.
4. Turn 180° either clockwise or anti-clockwise depending on which side the operating function is required.
5. Check the function has been set correctly using split spindle and handle.
6. Replace bolt in chosen orientation.